

INSULATED METAL WALL PLANK

Carron and Company (Insulated Metal Wall Plank) has been manufacturing insulated metal sandwich panels or "planks" since 1969. Over 50 years of design, manufacturing and installation experience have resulted in a time proven, cost-effective performance record.

WP-8 Panel

The WP-8 sandwich panel is the solution to the paradox of maximizing thermal efficiency while minimizing construction cost. The panel is ideal for industrial, commercial and institutional applications.



Our factory laminated, interlocking panels feature double tongue and groove construction incorporating non-mechanically fastened concealed securing clips. (No screws!) Flashings and closures are self draining.

The flat profiled panels are clad in steel, utilize a foam insulating core, and are available in a variety of finishes. Years of engineering and manufacturing know-how result in products which offer architectural design freedom and provide for one-step economical installation and maintenance free durability. For more detailed information on the WP-8 panel, please refer to our website at www.carronandco.com.

Panel Features and Applications

The WP-8 panel features:

- Simple design utilizing concealed fastening clips
- Light weight handling and installation
- Easy notching and cutting (each plank is 8" wide)
- "Flat" surface appeal
- Panels are factory laminated and can't "blister"

Typical applications for the WP-8 panel include:

- Exterior wall enclosures for warehouses, factories or offices
- Penthouse walls
- Interior wall partitions
- Explosion release wall sections
- Energy efficient retrofits of existing window systems
- Exterior wall installation from "inside" the building

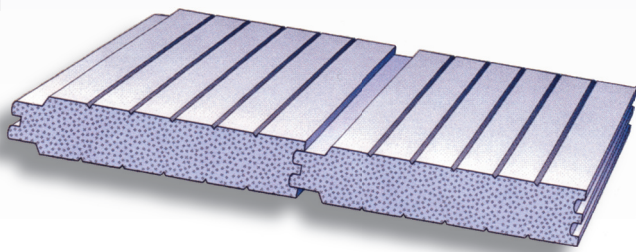

Panel Sizes

Standard sizes are as follows:

Width:	8"
Length:	4'- 0" to 27'- 0"
Thickness:	2" Standard 3" or 4" Optional

Faces and Finishes

Exterior and interior panel faces are smooth texture, 26 ga. galvanized steel with factory applied finishes.

The exterior face is available in a variety of colors in either Kynar 500® or silicone modified polyester finishes. The interior face is typically finished in Polar White silicone modified polyester.

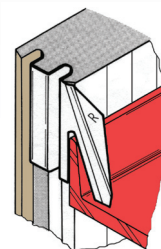

Concealed
Fastening
Clip

TEL: **815-733-5044**

WWW.CARRONANDCO.COM

See Our Website For Additional Products And Information

INSULATED METAL WALL PLANK

Foam Insulating Core

Standard insulating core for the *WP-8* panel is expanded polystyrene foam (EPS) in standard 2" thickness (3" and 4" optional). EPS is a closed cell, light weight, mildew resistant foamed plastic insulating material.

EPS Insulating Core

Thickness	2"	3"	4"
Density	1.5 pcf	1.5 pcf	1.5 pcf
R-Value (at 25° F)	9.64	14.46	19.28
Flame Spread	20	20	20
Smoke Developed	400	400	400

Test Data

The *WP-8* panel is able to sustain a 100 mph wind load (25 psf) at an 8'- 0" girt spacing.

The *WP-8* panel was tested for water and air infiltration per ASTM E331-86 and ASTM E283-84 standards. There was no observable water penetration to the interior face through the panel joints at 6.54 psf pressure differential. Air infiltration did not exceed .04 cfm per square foot of wall area at 1.57 psf.



Accessories

Metal flashings and trim are factory formed from the same material and finish as the panel face.

Self-draining bottom and corner closures are fabricated from 20 ga. galvanized steel with 26 ga. wrapper to match panel face.

The *WP-8* panel system incorporates non-mechanically fastened concealed clips to secure panels to the structural frame. The concealed clips are fabricated from 22 ga. galvanized steel. The concealed clips secure both the exterior and the interior faces to each structural support member.

As a matter of design, the *WP-8* panel does not require screw fasteners. Side lap caulking is not required nor is it recommended. Installation is fast, simple and economical.

Carron and Company
16108 S. Route 59, Unit 108
Plainfield, IL 60586
www.carronandco.com

Tel: 815-733-5044
contact.sales@carronandco.com